

The Carmel

PLAN OF THE MONTH | May 2011

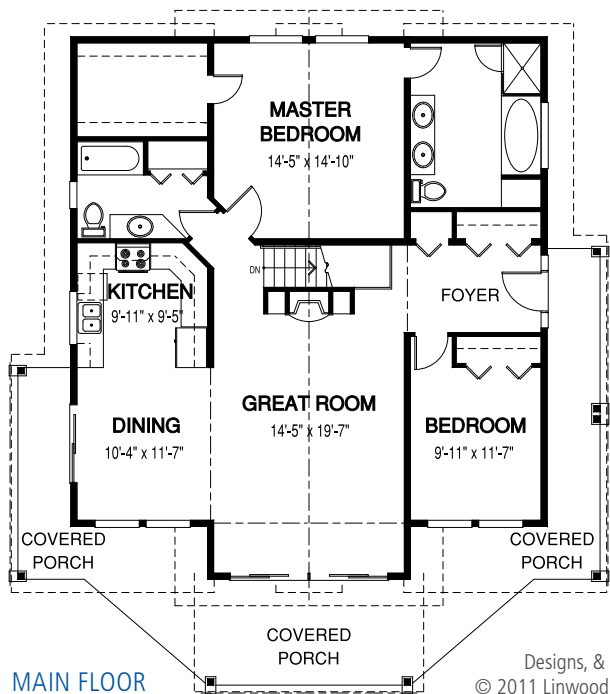

WIDTH: 44 ft. | DEPTH: 49 ft. | MAIN FLOOR: 1393 sq. ft. | TOTAL AREA: 1393 sq. ft.



Like its namesake in western California, Linwood's Carmel has sweet appeal. This home package is greatly admired for its beautiful design and use of exceptional building materials.

Can be ordered in:

P Post & Beam Specification

[Click here to view hundreds of Linwood floor plans and designs.](#)

 **LINWOOD**
CUSTOM HOMES

www.linwoodhomes.com

Designs, & Plans
© 2011 Linwood Homes Ltd.

Contact your Linwood representative for a price, or call: U.S. & Canada: 1-888-546-9663